

Building Sketch

Borrower/Client	Phillips, Nathan G			
Property Address	9 Rock Garden Gully			
City	Taos	County Taos	State NM	Zip Code 87571
Lender	Southwest Funding			

FOR VISUAL AID ONLY

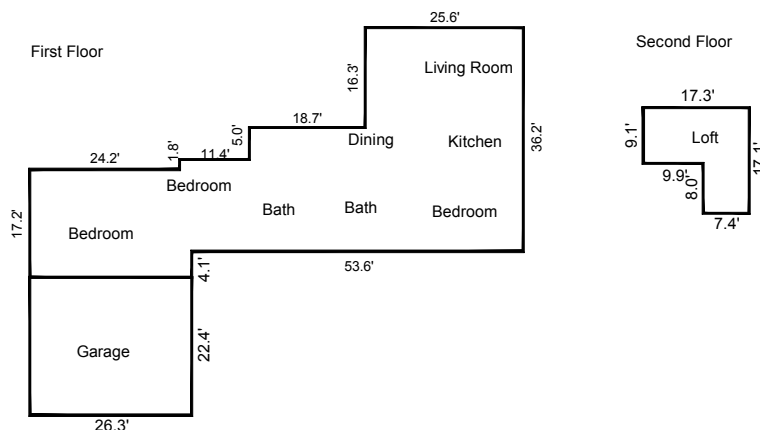

Sketch by Apex IV™

Comments:

AREA CALCULATIONS SUMMARY			
Code	Description	Size	Net Totals
GLA1	First Floor	1891.63	1891.63
GLA2	Second Floor	216.60	216.60
GAR	Garage	588.26	588.26
TOTAL LIVABLE (rounded)			2108

LIVING AREA BREAKDOWN			
Breakdown			Subtotals
First Floor			
19.9	x	44.3	881.33
11.4	x	14.9	169.53
16.3	x	25.6	417.56
13.1	x	24.2	316.12
4.1	x	26.3	107.10
Second Floor			
7.4	x	17.1	126.05
9.1	x	9.9	90.55
7 Calculations Total (rounded)			2108