

Building Sketch

Borrower/Client HERRERA, E & R			
Property Address 431 CAMINO DEL MEDIO			
City TAOS	County TAOS	State NM	Zip Code 87571-4329
Lender BANK OF OKALHOMA			

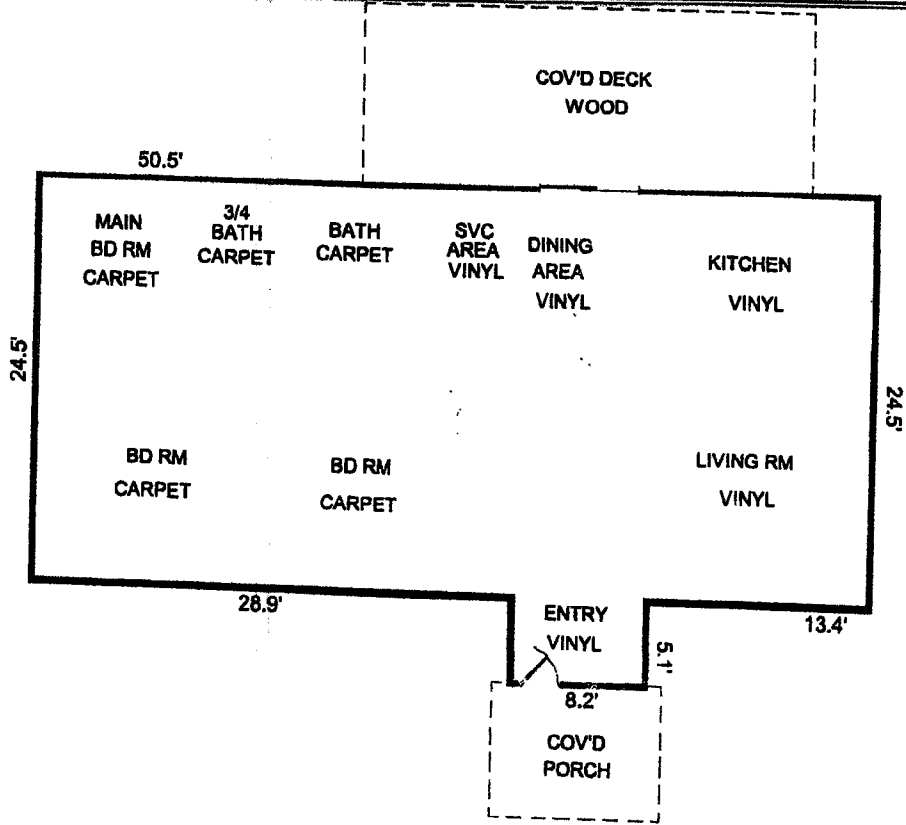

Sketch by Apex IV™

Comments:

AREA CALCULATIONS SUMMARY			
Code	Description	Size	Net Totals
GLA1	First Floor	1279.07	1279.07
TOTAL LIVABLE		(rounded)	1279

LIVING AREA BREAKDOWN		
Breakdown		Subtotals
First Floor		
5.1	x 8.2	41.82
24.5	x 50.5	1237.25
2 Calculations Total (rounded)		1279